

**HEX**TL™

---

**WIRELESS SPEAKER**

QUICK  
START  
GUIDE

## Getting to know Bluetooth

Bluetooth wireless is a quick and easy way to connect a smartphone to a speaker or a headset. There are basically two steps to making Bluetooth work.

### PAIRING:

The two devices get to know each other.



### CONNECTING:

The two devices do something together (like play music).



This guide takes you through the steps to get started.

# Step 1: Unpack

Make sure the following items came in this package.

Your speaker

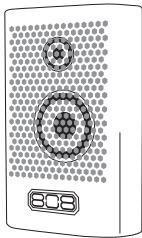

AC adapter



Audio cable



## Step 2: Charge

Before you start using the HEX TL speaker for the first time, it's a good idea to charge it completely.

**To charge the speaker:** Plug the included AC adapter into the **DC IN** jack on the back of the speaker.

Plug the other end of the AC adapter into a wall outlet.

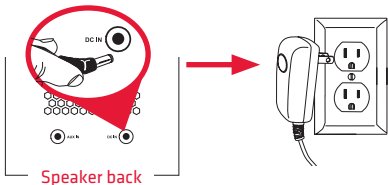

The **BATTERY** indicator on the top of the speaker is red while the speaker is charging. It turns green when the speaker is fully charged.

**Note:** You can use the speaker while it's charging.

## Step 3: Turn on

Press the  button on top of the speaker to turn it on. The speaker gives an audio signal and the **STATUS** indicator light on top of the speaker starts blinking.

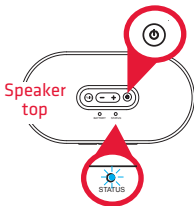

If this is the first time you're using the speaker, it automatically goes to Bluetooth pairing mode to set up with your smartphone.

## Step 4: Pair + Connect

Enable Bluetooth on your smartphone or other device.



Make sure the **STATUS** light on the top of the speaker is blinking rapidly. (If it isn't, press and hold the **PAIR** button until the speaker gives an audio signal.)

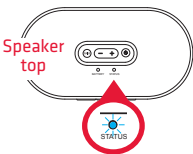

If you've previously paired your phone or other Bluetooth device with this speaker, the speaker will automatically attempt to reconnect to that device when you switch the speaker on. If you want to pair to a new device, press and hold the **PAIR** button on the speaker until the speaker gives an audio signal.

Choose **808 Hex TL** from the pairing options on your smartphone. (If it's not in the list, choose "Scan" from your phone's Bluetooth menu.)

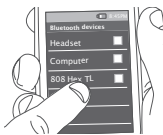

The speaker gives an audio signal when it's finished pairing and connecting to your smartphone. The **STATUS** indicator on the top of the speaker turns solid blue.

**Note:** The process of enabling Bluetooth and connecting varies from device to device. See your device's owners manual for more information and specific instructions.

#### Bluetooth Wireless Connection Tips

- Make sure the Bluetooth capability of your device is turned on.
- Make sure there's nothing plugged into the speaker's AUX IN jack when you're trying to use Bluetooth.
- The Bluetooth wireless connection works up to a range of roughly 33 feet (10 meters). This range may vary, however, based on other factors, such as room layout, wall material, obstacles, your device's Bluetooth performance, etc. If you're having problems connecting to this speaker, move closer to it.
- Make sure your device supports audio transfer A2DP.
- If your device asks you for a password to connect, use "0000".

## Step 5: Play music

Set your device's volume for music to 75%.

**Note:** This is to make sure the sound from the speaker isn't too loud when you start streaming.



Start playing music or other audio on your device. Within seconds, the speaker starts streaming the audio wirelessly via Bluetooth.



**To adjust the volume of your audio:** Use the – and + buttons on top of the speaker. You can also use the volume controls on your phone.



**Notes:** When you reach the speaker's maximum volume, the **STATUS** indicator blinks when you press the + button. If you notice sound distorting even at low volumes, turn the volume down on your phone.



## Using the AUX IN input

Use the audio cable included with this speaker to connect the audio output from your device to the **AUX IN** audio input on the speaker's back panel. The speaker automatically switches to the **AUX IN** audio.

To listen to Bluetooth audio again, unplug the cable from the speaker's **AUX IN** jack.

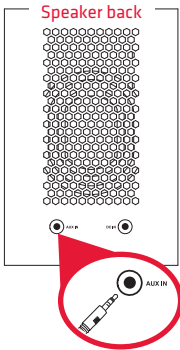

# Tour of the speaker

## Top of the speaker

**PAIR** button puts the speaker into pairing mode to connect to a new Bluetooth device, like a smartphone.

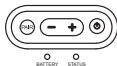

– and + adjust the volume of the speaker.

⏻ turns the speaker on and off.

**STATUS light** shows the Bluetooth pairing and connection status of the speaker:

- fast blinking while pairing
- slow blinking while reconnecting
- solid blue when connected via Bluetooth
- solid white when **AUX IN** jack is in use
- off when the speaker's off.

**BATTERY light** shows the charging status of the speaker: red when charging, green when fully charged.

### Back of the speaker

**AUX IN** jack lets you connect an audio device directly to the speaker using the provided audio cable.

**DC IN** jack connects to the provided power adapter to plug the speaker into a power outlet.



For more information about your new HEX TL speaker, see the User Guide.

If you have any questions about this product, visit [808Audio.com](http://808Audio.com) or call our toll-free help line at 1-800-732-6866.

SP901 QSG 01