

### Finding the best location for the antenna

Before you connect the antenna, determine the best spot in your home for optimum reception. Visit [www.antennaweb.org](http://www.antennaweb.org) to see where your local broadcasts are coming from. Then, try as much as possible to avoid obstructions between these transmitters and your antenna.

#### IMPORTANT NOTES ABOUT ANTENNA PLACEMENT:

Although the ANT1050 may perform well when placed near or on electronics such as TVs, these electronics may also interfere with the antenna's reception. If you experience reception difficulties with the ANT1050, try moving it away from your TV or other nearby electronic devices.

The ANT1050 works when on a flat surface or stretched horizontally on a wall or window. It will not work when stretched vertically on a wall or window.

*Note: Many times the best location for the antenna is close to or on a window. You can use two-sided tape to mount to a window pane.*

### Assembling the ANT1050

**IMPORTANT:** Remove protective film from the antenna wing sections before assembling the antenna.

- Remove all parts from the box. The ANT1050 antenna package includes the following items:
 

1 Middle Section	2 Antenna Wing Sections
(with coaxial cable)	1 Antenna T-Bar
3 Screws and Nuts	
- Unscrew the single screw holding the middle section together. Remove the top of the middle section. Uncoil and extend the coaxial cable built into this section.

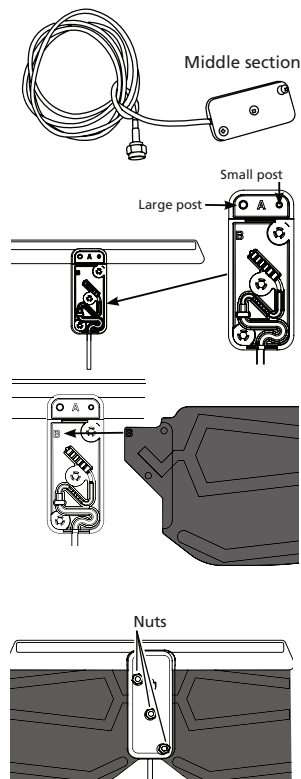

- Insert the three screws into the holes on the outside of the top of the middle section. Hold the screws in place and flip the top of the middle section over. Set it on a flat surface.
- Place the antenna T-Bar (labeled A) on the middle section top so that the large hole in the T-Bar fits over the large post. **IMPORTANT:** The T-Bar must be installed for the antenna to work properly.
- Find the antenna wing section labeled B. Line the screw holes in this antenna wing up with the screws inserted in the middle section top so that the B on the antenna wing lines up with the B on the middle section top. Lower the holes onto the screws.
- Find the other antenna wing section. Line the screw holes in this antenna wing up with the screws inserted in the middle section top so that the C on the antenna wing is in the bottom right corner of the middle section top. Lower the holes onto the screws.

- Place the bottom of the middle section on the top of the middle section. Make sure to line up the holes with the screws.
- Flip the entire assembly over and carefully tighten the screws. DO NOT overtighten.
- Connect the coaxial cable to your TV's antenna input.

### Note about digital channels

To display digital signals on your TV, you'll need to have the right equipment: either a TV that is capable of decoding digital signals or a digital converter box.

### Troubleshooting

#### I have a cable ready TV. Why can't I get channels above 13?

The tuners inside of cable ready TVs have two modes: one for cable and one for antenna. When the TV is in cable mode, and you are using an antenna, you will not be able to receive any channels above 13. To fix this, simply access the menu of your TV and switch the TV from Cable/CATV mode to ANT/AIR mode.

#### I have my TV in a metal cabinet. Will the antenna work for me?

Any large metal objects will prevent the antenna signal from reaching the antenna. You must place the antenna outside of or above the metal cabinet.

#### My home has aluminum siding/insulation. Where should I place my antenna?

Place the antenna near a window to minimize interference and improve your reception.

#### Can I use my antenna in a basement?

TV signals usually cannot penetrate into basement locations due to their lower elevation.

**Please Note:** Other variables, unrelated to antenna performance, can effect your reception. These include distance from the broadcasting source, and natural or man-made conditions (such as buildings between the transmitting source and your antenna).

### 12 Month Limited Warranty

Audiovox Electronics Corporation (the "Company") warrants to the original retail purchaser of this product that should this product or any part thereof, under normal use and conditions, be proven defective in material or workmanship within 12 months from the date of original purchase, such defect(s) will be repaired or replaced (at the Company's option) without charge for parts and repair labor. To obtain repair or replacement within the terms of this Warranty, the product along with any accessories included in the original packaging is to be delivered with proof of warranty coverage (e.g. dated bill of sale), specification of defect(s), transportation prepaid, to the Company at the address shown below. Do not return this product to the Retailer.

This Warranty is not transferable and does not cover product purchased, serviced or used outside the United States or Canada. The Warranty does not extend to the elimination of externally generated static or noise. This Warranty does not apply to costs incurred for installation, removal or reinstallation of the product, or, if in the Company's opinion, the product has been damaged through acts of nature, alteration, improper installation, mishandling, misuse, neglect, or accident. This Warranty does not cover damage caused by an AC adapter not provided with the product.

THE EXTENT OF THE COMPANY'S LIABILITY UNDER THIS WARRANTY IS LIMITED TO THE REPAIR OR REPLACEMENT PROVIDED ABOVE AND, IN NO EVENT, SHALL THE COMPANY'S LIABILITY EXCEED THE PURCHASE PRICE PAID BY PURCHASER FOR THE PRODUCT.

This Warranty is in lieu of all other express warranties or liabilities. ANY IMPLIED WARRANTIES, INCLUDING ANY IMPLIED WARRANTY OF MERCHANTABILITY OR FITNESS FOR A PARTICULAR PURPOSE, SHALL BE LIMITED TO DURATION OF THIS WARRANTY. ANY ACTION FOR BREACH OF ANY WARRANTY HEREUNDER, INCLUDING ANY IMPLIED WARRANTY, MUST BE BROUGHT WITHIN A PERIOD OF 24 MONTHS FROM THE DATE OF ORIGINAL PURCHASE. IN NO CASE SHALL THE COMPANY BE LIABLE FOR ANY CONSEQUENTIAL OR INCIDENTAL DAMAGES WHATSOEVER. No person or representative is authorized to assume for the Company any liability other than expressed herein in connection with the sale of this product.

Some states/provinces do not allow limitations on how long an implied warranty lasts or the exclusion or limitation of incidental or consequential damage so the above limitations or exclusions may not apply to you. This Warranty gives you specific legal rights and you may also have other rights which vary from state/province to state/province.

**U.S.A.:** Audiovox Electronics Corporation, 150 Marcus Blvd., Hauppauge, NY 11788

**CANADA:** Audiovox Return Center, c/o Genco, 6685 Kennedy Road, Unit 3, Door 16, Mississauga, Ontario L5T 3A5